

# HOUSE AND LAND PACKAGE



## Haven

Worchester Facade Option



# From \$326,709

476SQM

LOT 24 HONOUR AVENUE  
CHAMPIONS ESTATE

- Estate Covenants & NBN
- Site Cost Allowance
- Driveway
- BAL 12.5 (if Required)
- 900mm Stainless Steel Free Standing Cooker
- 900mm Stainless Steel Canopy
- Tiled Shower Base
- 6 Star Energy Rating
- Rheem Solar Hot Water Service
- Gas Ducted Heating
- Carpets, Tiles & Floorboards
- Flyscreens & Garage Remote

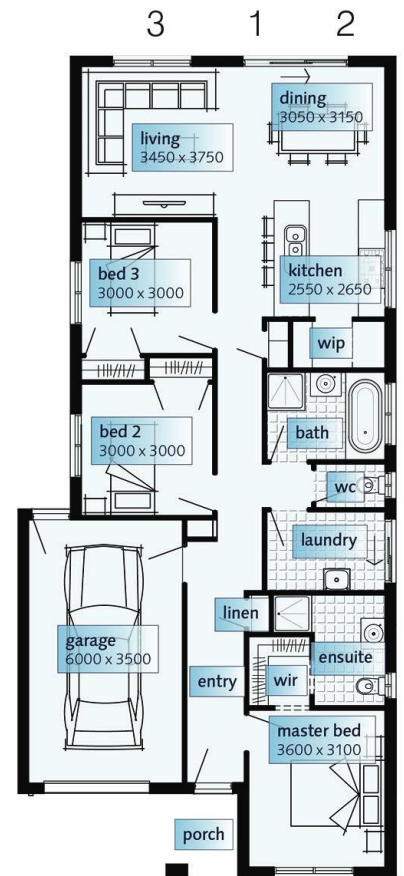

HAVEN		
Dimensions	SQ.M	Squares
Ground Floor	115.250m <sup>2</sup>	12.41Sqs
Porch	3.45m <sup>2</sup>	0.37Sqs
Garage	23.65m <sup>2</sup>	2.55Sqs
Total area	142.35m <sup>2</sup>	15.32Sqs

Width	8.60m
Depth	19.07m
Suggested minimum block width: 10.00m New Living range specification	

Please contact: SALES CONSULTANT

Name BRENT JACOBSSON

Number 0428 953 208



1300 SIMONDS [simonds.com.au](http://simonds.com.au)

**SIMONDS**  
we're in it together

Images shown for illustrative purposes and may not represent the final product. Prices are based on availability and price of land. Simonds reserves the right to alter any price or substitute any home without prior notice. All house and land packages are subject to developers' final approval. In the event that a Homesite does not have Survey Pegs in place to identify lot boundary then an additional charge will be added to the cost of the house.