

# HOUSE AND LAND PACKAGE



Orion

Dublin Facade Option



From **\$358,279**

LOT 27 RACING WAY

CHAMPIONS ESTATE

Estate Covenants

Site Cost Allowance & Driveway

BAL 12.5 & NBN

900mm Stainless Steel Free Standing Cooker

900mm Stainless Steel Canopy

Tiled Shower Base

6 Star Energy Rating

Rheem Solar Hot Water Service

Gas Ducted Heating

Tiles to Wet Areas. Carpets. Floorboards & Garage Remote

476M2

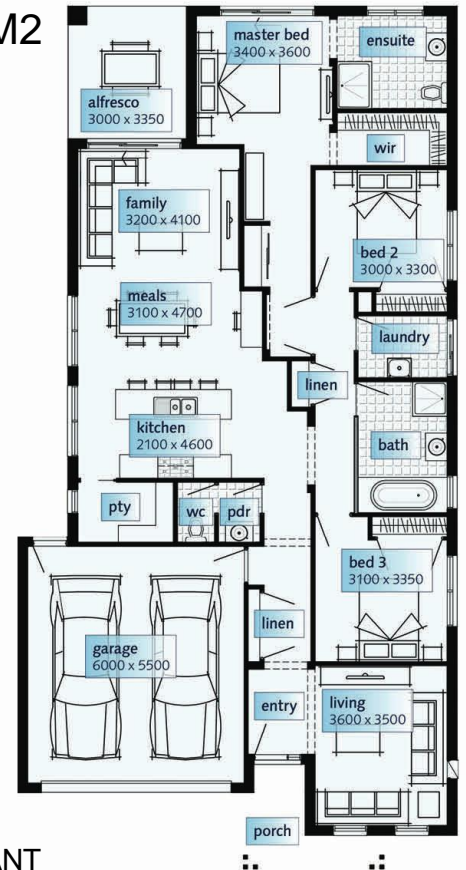

## ORION

| Dimensions   | SQ.M                 | Squares  |
|--------------|----------------------|----------|
| Ground Floor | 161.00m <sup>2</sup> | 17.33Sqs |
| Porch        | 6.62m <sup>2</sup>   | 0.71Sqs  |
| Alfresco     | 10.08m <sup>2</sup>  | 1.09Sqs  |
| Garage       | 36.06m <sup>2</sup>  | 3.88Sqs  |
| Total area   | 213.76m <sup>2</sup> | 23.01Sqs |

|   |        |
|---|--------|
| Width   | 11.10m |
| Depth   | 21.99m |
| Suggested minimum block width: 12.50m<br>New Living range specification |        |

Please contact: SALES CONSULTANT

Name BRENT JACOBSSON

Number 0428 953 208



1300 SIMONDS [simonds.com.au](http://simonds.com.au)

**SIMONDS**  
we're in it together

Images shown for illustrative purposes and may not represent the final product. Prices are based on availability and price of land. Simonds reserves the right to alter any price or substitute any home without prior notice. All house and land packages are subject to developers' final approval. In the event that a Homesite does not have Survey Pegs in place to identify lot boundary then an additional charge will be added to the cost of the house.